

Hasp Cuff

Hasp cuffs are a simple but effective way of binding a submissive. Hasp cuffs must be held in place with padlocks, but compared with buckling cuffs, they're more secure, less bulky and often more comfortable.



Hasp cuffs are a good choice for small-boned submissives, particularly women. Women are often able to wriggle free from cuffs because they can often scrunch their hands down to almost the size of their wrists (generally, women have narrower hands than men).



If you don't mind attaching rope and chain to the padlock, you can leave off the D-ring and the smaller piece of leather (items 2 and 4).

To decide the final size for your cuff, consult the table. (The values are provided as guidelines only — leather thickness, hasp and lock size, padding, preferred tightness and forearm/ankle shape all affect the actual limb sizes that properly fit your cuffs.)

Most people have a wrist circumference between 5 9/16" and 8 13/32" [141 and 214 mm] so the smaller cuff should accommodate almost everyone. Even small subs should find the cuff inescapable, but you can always add a slot, if need be.



Most people have an ankle circumference between 6 1/2" and 10" [165 and 253 mm], though the great majority of people have a circumference greater than 7 1/2" [192 mm]. Thus, the larger cuff should accommodate most ankles.

To make a very nice set of wrist and ankle cuffs for a single wearer, attach a hasp to a strap, custom fit a single slotted hole, then cut the strap. This way, you get comfortable, good-looking cuffs that fit perfectly and take less effort to make because you don't have to cut as many slots.

If you want to add padding, increase the length of the cuff by 6 to 8 times the thickness of the padding. Thus, if your

Strap Length and Limb Circumference

Strap Length (Item 1)	Circumference Range
Wrist 12" [300 mm]	min.: 6" [150 mm] max.: 9" [225 mm]
Ankle 13 1/2" [338 mm]	min.: 7 1/2" [188 mm] max.: 10 1/2" [263 mm]
Custom X" [Y mm]	min.: X - 6" [Y - 150 mm] max.: X - 3" [Y - 75 mm]

SECURE CUFFS

To be secure, hasp cuffs usually need fairly large padlocks. Large padlocks are a bit of a menace, particularly when your sub is wearing cuffs but not otherwise bound. If your sub tries to caress you, you may end up with a concussion, nasty bruise or a nauseating reminder that testicles and large padlocks don't mix.



Unfortunately, small padlocks may not hold your sub securely if your hasp cuffs or straps are made with thin leather.



To make your toys secure, even with small padlocks, cut a plate out of steel or thick leather and put it over the hasp before you attach the lock.



You can make your own plates from scratch or by cutting off the end of the hinge that came with the hasp. You can also rivet the plate to the strap.

padding is 3 mm thick, increase the length of item 1 by 18 to 24 mm. (Six times compensates for the reduction in size of a *circular* cuff (2p), eight times for a *rectangular* cuff — in truth, the cuff is somewhere in between, but you don't have to be really accurate since the actual compression of the padding is a mystery anyway.)



These cuffs are comfortable without padding, but you should bevel the inside edges. If your sub has narrow hands, *don't* add padding — the extra “give” increases the risk of escape.

To design cuffs of your own, you can use the formula provided in the table. Naturally, if you use a long strap, you can accommodate a very wide range of waist/thigh/bicep circumferences. These measurements vary greatly (unlike wrists and ankles, whose circumferences aren't significantly affected by fat or muscle), so design the cuffs specifically to fit the intended wearer.

The toy shown below fits the waist of one submissive and has D-rings for restraining her wrists.



Finally, notice that the strap holding the D-ring (item 2) forces the cuff to curve. This feature makes the cuff more comfortable (see “Good Cuffs” on page 106).

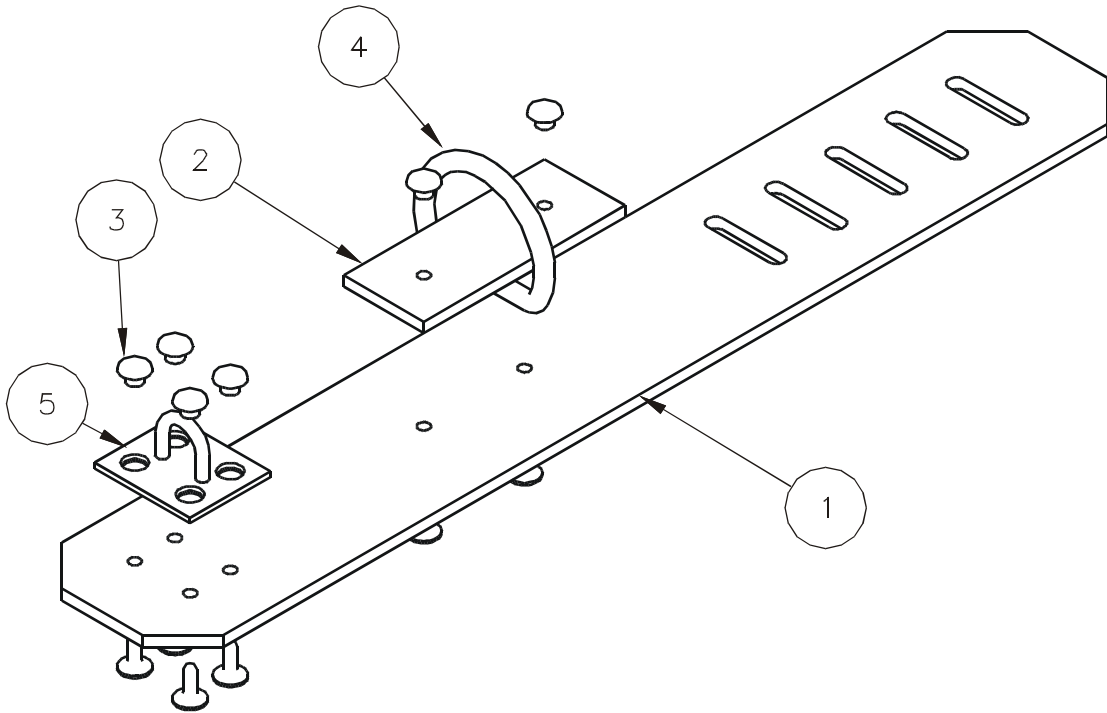

Item	Qty	Description
1	1	Leather, 8 oz. x 2" x As Required [3.2 x 50 mm x AR]
2	1	Leather, 8 oz. x 1" x 2 1/2" [3.2 x 25 x 63 mm]
3	6	Rivet (2 Layers)
4	1	D-Ring, 1" [25 mm]
5	1	Hasp, Small

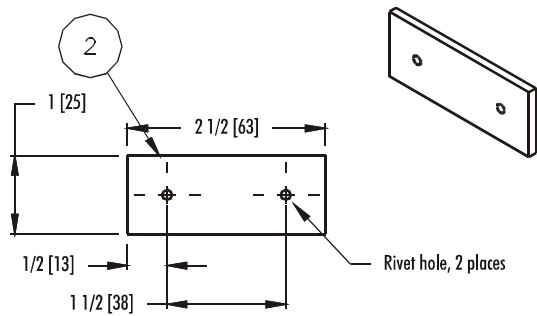
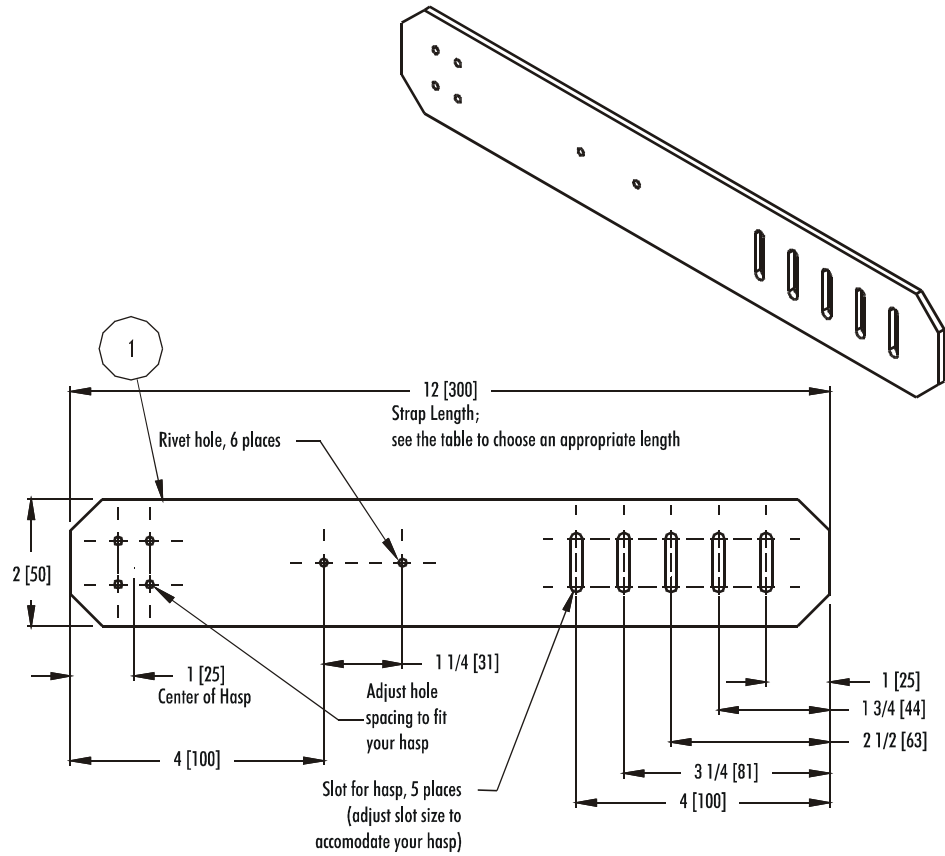

Copyright Douglas Kent 2005

Sample from:

*The Better Built Bondage Book: A
complete guide to making your own sex toys,
furniture and BDSM equipment*

To buy a copy or learn more, please visit:

www.TheBetterBuiltBondageBook.com

or

www.TBBbb.com (four B's)

This PDF may be freely distributed provided it is not modified. If possible, a link to one of the above URLs would be appreciated.